

Isover Protect Putty Cord

Fire stopping & sealing

Installation Instructions

INDEX

INDEX

General Guide	3
Installation	4

INDEX - TECHNICAL DRAWINGS

Blank seals in floors	5
Cables in floors	5-6
Steel pipes in floors	6-8
Copper pipes in floors	8-9
Alupex pipes in floors	9-10
Steel pipes in masonry or concrete walls	11
Copper pipes in masonry or concrete walls	11
Alupex pipes in masonry or concrete walls	11
Blank seals in drywalls, masonry or concrete walls	11
Cables in drywalls, masonry or concrete walls	12
Steel pipes in drywalls, masonry or concrete walls	12-13
Copper pipes in drywalls, masonry or concrete walls	13-14
Alupex pipes in drywalls, masonry or concrete walls	14-15
Plastic pipes in drywalls, masonry or concrete walls	15

General Guide

Isover Protect Putty Cord is an easy to apply fire rated putty supplied as a non-setting cord. The cord is hand workable, re-useable and re-serviceable due to its non-setting properties.

Isover Protect Putty Cord is designed to be easily fitted around service penetrations where the gap around the services is very small, or there is no gaps at all so a conventional fire rated sealant is impossible or difficult to fit due to the required depth and backing material. Isover Protect Putty Cords are fitted covering the gap around the services and do not need to fill the gap to the required depth. Fitting the Isover Protect Putty Cords will reinstate the fire rating of the partition and prevent the passage of smoke and flames in a fire, and sound and air movement during service life.

Isover Protect Putty Cords are supplied in strips with a round cross-section and are easy to fit with your thumbs; no tools are needed.

Minimum separations and limitations: Services can be sealed as specified in the detailed drawings. The product may be used to seal gaps between 0mm and 10mm surrounding services which may be angled between 90° and 45° in all directions. Minimum separation between apertures should be at least 30mm. For larger joint dimensions or apertures other than described in the detailed drawings, Isover Protect Acrylic, Isover Protect Coated Board or Isover Protect Mortar should be used. In areas with a high degree of humidity and/or in joints with excessive movement, Isover Protect FR IPT or Isover Protect Coated Board should be used.

Supporting constructions: Flexible walls must have a minimum thickness of 100mm and comprise steel studs or timber studs*) lined on both faces with minimum 2 layers of 12.5mm thick boards. Rigid walls must have a minimum thickness of 100mm and comprise concrete, aerated concrete or masonry, with a minimum density of 350kg/m³. Rigid floors must have a minimum thickness of 150mm and comprise aerated concrete or concrete with a minimum density of 350kg/m³. The supporting construction must be classified in accordance with EN 13501-2 for the required fire resistance period.

*) Timber studs: no part of the penetration seal may be closer than 100mm to a stud, and minimum 100mm of insulation of class A1 or A2 must be provided within the cavity between the penetration seal and the stud.

Installation

1. Before installing Isover Protect Putty Cord ensure that the surface of all service penetrations and surrounding construction is wiped clean, dry, free from all loose contaminants, dust, oils and grease.
2. To aid adhesion to porous substrates take a thumb size piece of the Isover Protect Putty Cord and gently rub over the required installation mounting area (especially important in soffit applications).
3. Where Isover Protect Putty Cord is to be installed against surfaces that cannot tolerate direct contact; appropriate surface preparation should be made (contact Isover for guidance in these cases). For paints sensitive to sealing compounds, priming with a PVA primer is recommended.
4. As Isover Protect Putty Cord is silicone based, in cases where corrosion protection is a problem; some metals may require a barrier between the putty and the metal surface prior to this installation.
5. When installing Isover Protect Putty Cord in hollow floor slabs or boards, fire seals should be installed from the soffit side of the floor assuming this product certification covers the application. Where this is not the case and only top-sided applications are approved, simply fire seal on both sides.
6. Place the Isover Protect Putty Cord around the services so that it seals the services to the wall or floor all the way round.
7. Press the Isover Protect Putty Cord into the wall or floor and services with your thumbs to form a fillet or V shape joint, ensuring good contact is made all the way round the services and the wall or floor.

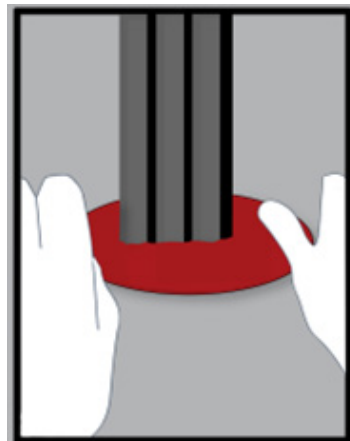
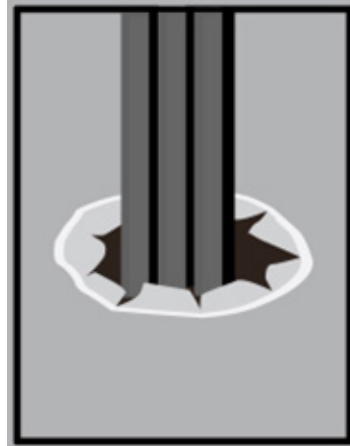
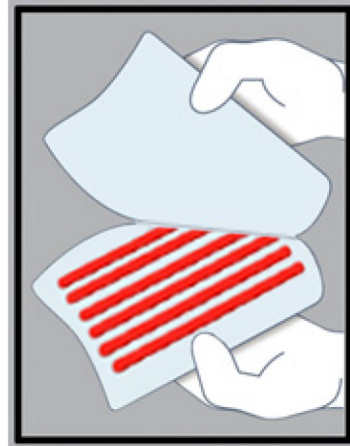

BLANK SEAL FIRE RESISTANCE EI 30 (E 120)

RIGID FLOORS

Maximum aperture
Ø15mm

≥ 15mm deep Isover Protect Putty Cord applied flush on soffit side

BLANK SEAL FIRE RESISTANCE EI 120 (E 120)

RIGID FLOORS

Maximum aperture
Ø14mm

≥ 15mm deep Isover Protect Putty Cord applied flush on both sides

CABLE FIRE RESISTANCE EI 120 (E 120)

RIGID FLOORS

Apertures with less than 10mm annular width around services

Isover Protect Putty Cord on top side oversailing the aperture

Cable ≤ Ø21mm

CABLE FIRE RESISTANCE EI 90 (E 120)

RIGID FLOORS

Apertures with less than 10mm annular width around services

Isover Protect Putty Cord on top side oversailing the aperture

Cable ≤ Ø50mm

CABLE FIRE RESISTANCE EI 60 (E 120)

RIGID FLOORS

Apertures with less than 10mm annular width around services

Isover Protect Putty Cord on top side oversailing the aperture

Cable ≤ Ø80mm

CABLES FIRE RESISTANCE EI 60 (E 120)

RIGID FLOORS

Apertures with less than 10mm annular width around services

Isover Protect Putty Cord on top side oversailing the aperture

Cables ≤ Ø21mm in tied bundle ≤ Ø50mm

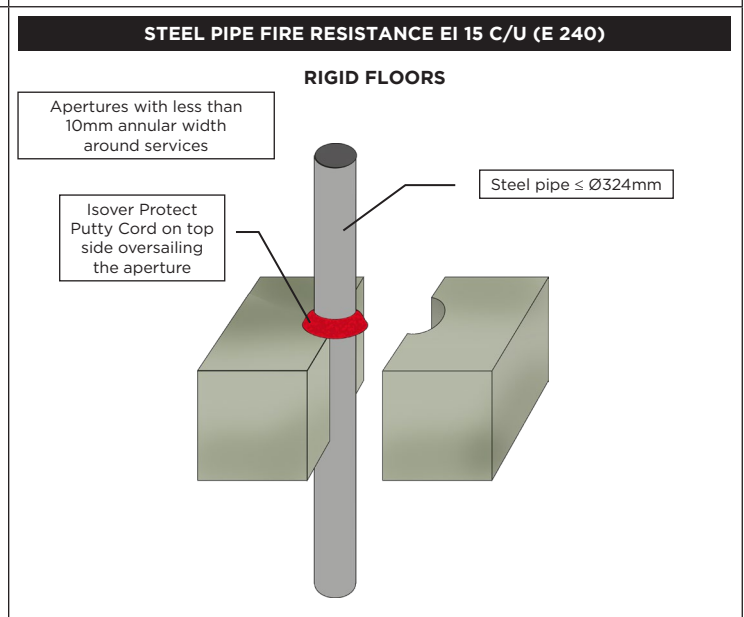
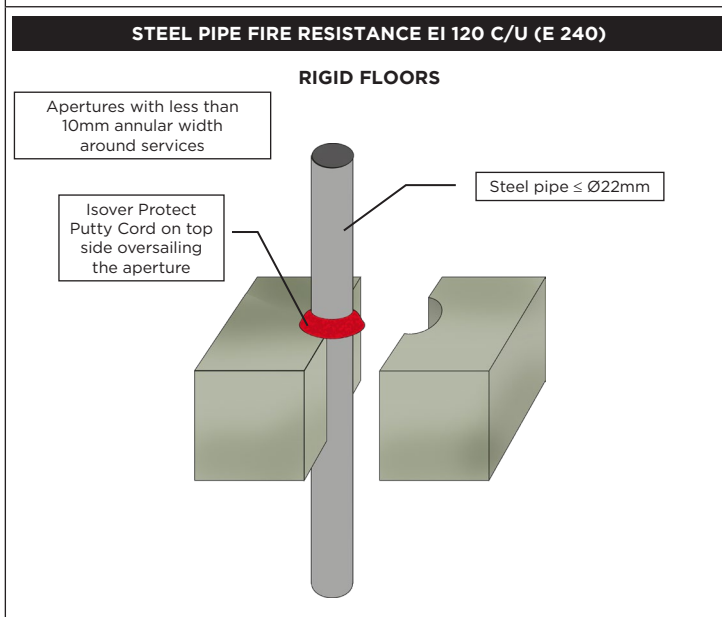
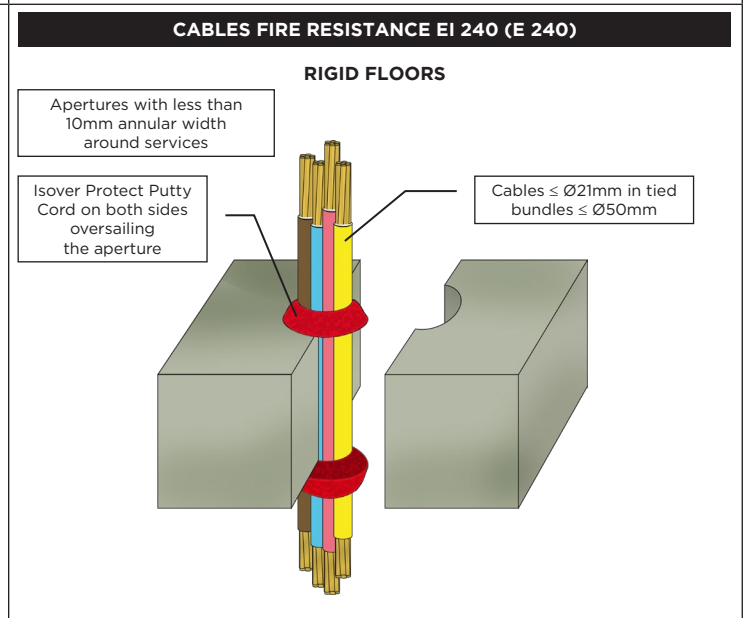
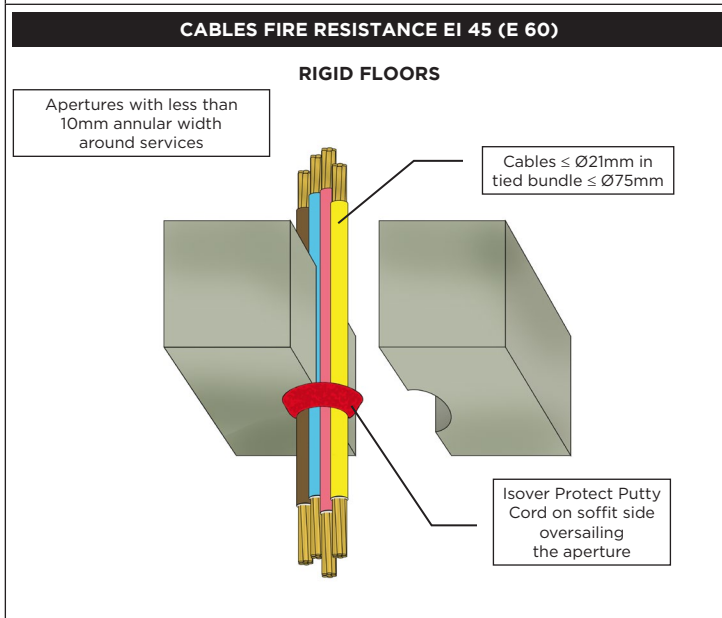
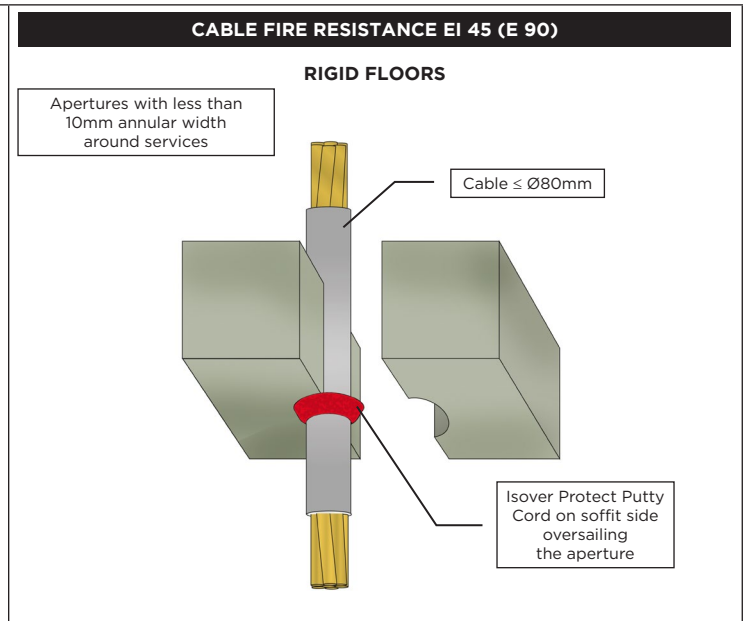
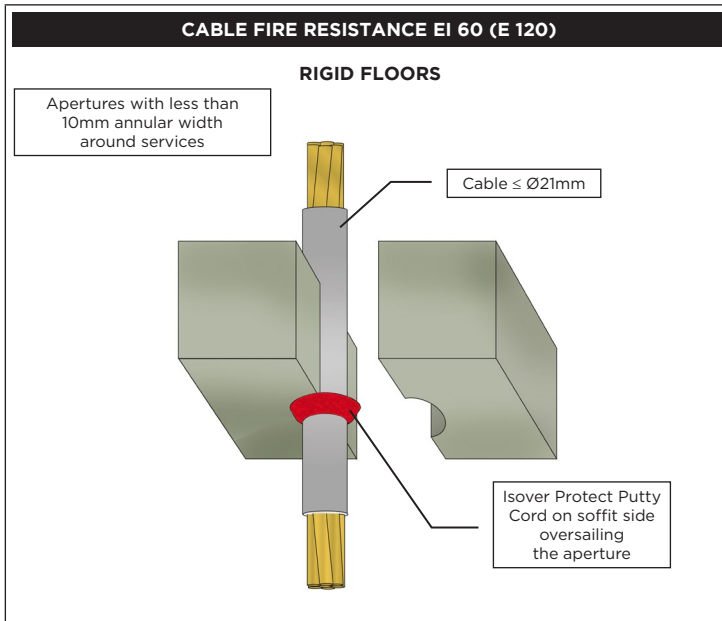

<p>STEEL PIPE FIRE RESISTANCE EI 45 C/U (E 120)</p> <p>RIGID FLOORS</p> <p>Apertures with less than 10mm annular width around services</p> <p>Steel pipe $\leq \varnothing 30\text{mm}$</p> <p>Isover Protect Putty Cord on soffit side oversailing the aperture</p>	<p>STEEL PIPE FIRE RESISTANCE EI 120 C/U (E 180)</p> <p>RIGID FLOORS</p> <p>Apertures with less than 10mm annular width around services</p> <p>Steel pipe $\leq \varnothing 40\text{mm}$</p> <p>Isover Protect Putty Cord on top side oversailing the aperture</p> <p>20mm continuous pipe insulation of Isover Glass Wool $\geq 75\text{kg/m}^3$</p>
<p>STEEL PIPE FIRE RESISTANCE EI 240 C/U (E 240)</p> <p>RIGID FLOORS</p> <p>Apertures with less than 10mm annular width around services</p> <p>Steel pipe $\leq \varnothing 40\text{mm}$</p> <p>Isover Protect Putty Cord on top side oversailing the aperture</p> <p>20mm continuous pipe insulation of Isover Stone Wool $\geq 80\text{kg/m}^3$</p>	<p>STEEL PIPE FIRE RESISTANCE EI 240 C/U (E 240)</p> <p>RIGID FLOORS</p> <p>Apertures with less than 10mm annular width around services</p> <p>Steel pipe $\leq \varnothing 324\text{mm}$</p> <p>Isover Protect Putty Cord on top side oversailing the aperture</p> <p>30-80mm continuous pipe insulation of Isover Stone Wool $\geq 80\text{kg/m}^3$</p>
<p>STEEL PIPE FIRE RESISTANCE EI 180 C/U (E 180)</p> <p>RIGID FLOORS</p> <p>Apertures with less than 10mm annular width around services</p> <p>Steel pipe $\leq \varnothing 40\text{mm}$</p> <p>Isover Protect Putty Cord on top side oversailing the aperture</p> <p>$\geq 20\text{mm}$ pipe insulation of glass wool $\geq 75\text{kg/m}^3$ $\geq 50\text{cm}$ on both sides</p>	<p>STEEL PIPE FIRE RESISTANCE EI 240 C/U (E 240)</p> <p>RIGID FLOORS</p> <p>Apertures with less than 10mm annular width around services</p> <p>Steel pipe $\leq \varnothing 40\text{mm}$</p> <p>Isover Protect Putty Cord on top side oversailing the aperture</p> <p>$\geq 20\text{mm}$ pipe insulation of Isover Stone Wool $\geq 80\text{kg/m}^3$ $\geq 50\text{cm}$ on both sides</p>

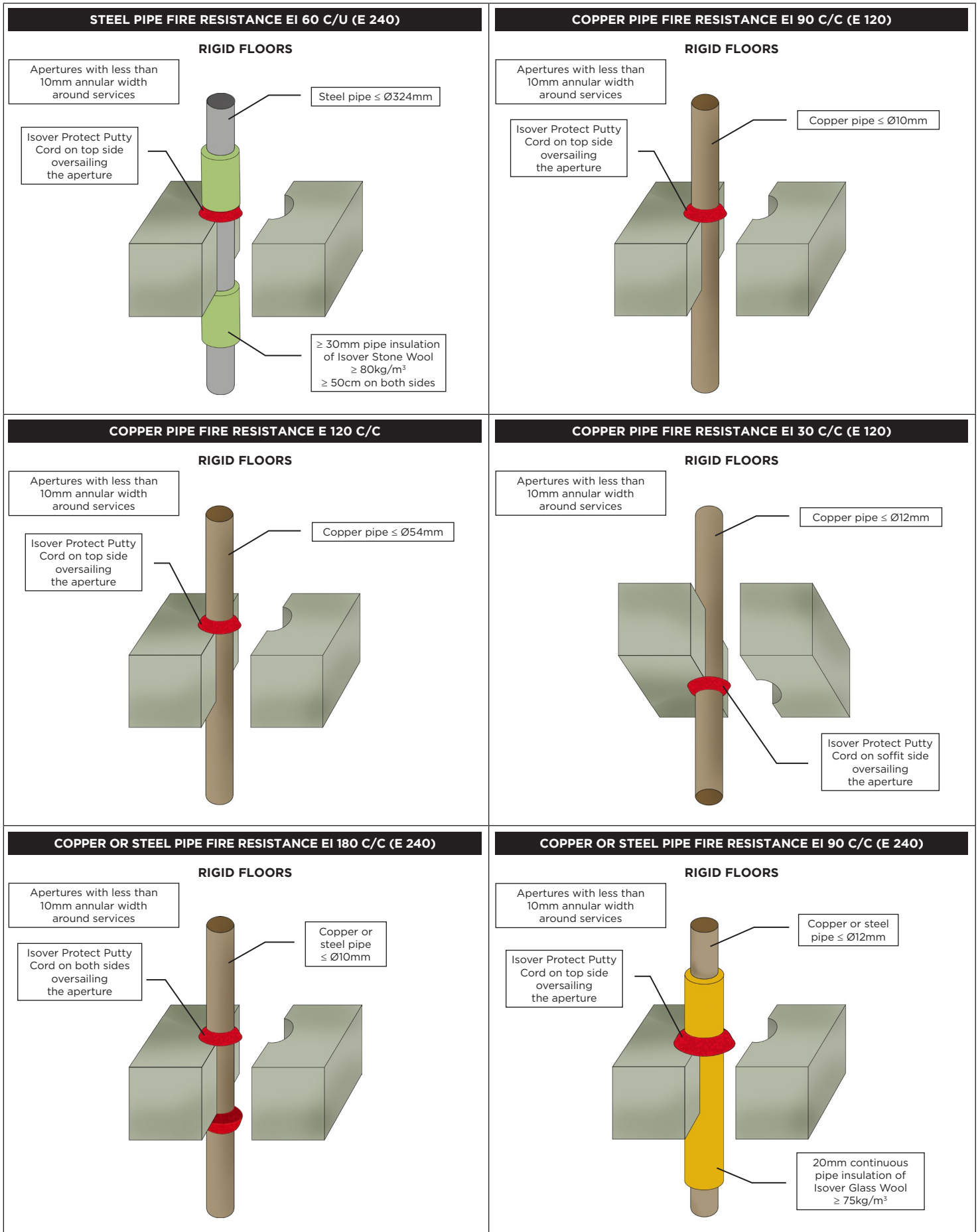

<p>COPPER OR STEEL PIPE FIRE RESISTANCE EI 90 C/C (E 90)</p> <p>RIGID FLOORS</p> <p>Apertures with less than 10mm annular width around services</p> <p>Isover Protect Putty Cord on top side oversailing the aperture</p> <p>Copper or steel pipe $\leq \varnothing 54\text{mm}$</p> <p>20-40mm continuous pipe insulation of Isover Glass Wool $\geq 75\text{kg/m}^3$</p>	<p>COPPER PIPE FIRE RESISTANCE EI 240 C/C (E 240)</p> <p>RIGID FLOORS</p> <p>Apertures with less than 10mm annular width around services</p> <p>Isover Protect Putty Cord on top side oversailing the aperture</p> <p>Copper pipe $\leq \varnothing 12\text{mm}$</p> <p>20mm continuous pipe insulation of Isover Stone Wool $\geq 80\text{kg/m}^3$</p>
<p>COPPER PIPE FIRE RESISTANCE EI 240 C/C (E 240)</p> <p>RIGID FLOORS</p> <p>Apertures with less than 10mm annular width around services</p> <p>Isover Protect Putty Cord on top side oversailing the aperture</p> <p>Copper pipe $\leq \varnothing 54\text{mm}$</p> <p>30-80mm continuous pipe insulation of Isover Stone Wool $\geq 80\text{kg/m}^3$</p>	<p>COPPER OR STEEL PIPE FIRE RESISTANCE EI 240 C/C (E 240)</p> <p>RIGID FLOORS</p> <p>Apertures with less than 10mm annular width around services</p> <p>Isover Protect Putty Cord on top side oversailing the aperture</p> <p>Copper or steel pipe $\leq \varnothing 12\text{mm}$</p> <p>$\geq 20\text{mm}$ pipe insulation of Isover Glass or Stone Wool $\geq 75\text{kg/m}^3 \geq 50\text{cm}$ on both sides</p>
<p>COPPER OR STEEL PIPE FIRE RESISTANCE EI 120 C/C (E 180)</p> <p>RIGID FLOORS</p> <p>Apertures with less than 10mm annular width around services</p> <p>Isover Protect Putty Cord on top side oversailing the aperture</p> <p>Copper or steel pipe $\leq \varnothing 54\text{mm}$</p> <p>$\geq 20\text{mm}$ pipe insulation of Isover Glass or Stone Wool $\geq 75\text{kg/m}^3 \geq 50\text{cm}$ on both sides</p>	<p>ALUPEX PIPE FIRE RESISTANCE EI 240 C/C (E 240)</p> <p>RIGID FLOORS</p> <p>Apertures with less than 10mm annular width around services</p> <p>Isover Protect Putty Cord on top side oversailing the aperture</p> <p>Alupex pipe $\leq \varnothing 20\text{mm}$</p>

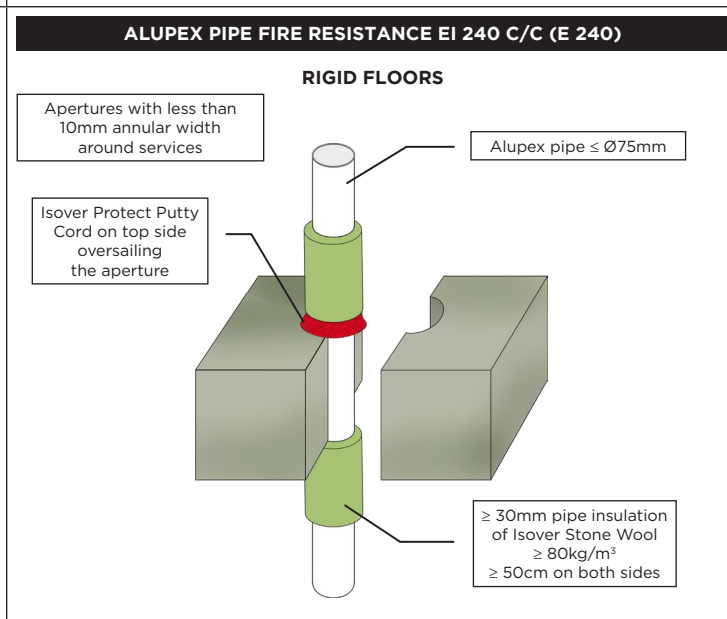
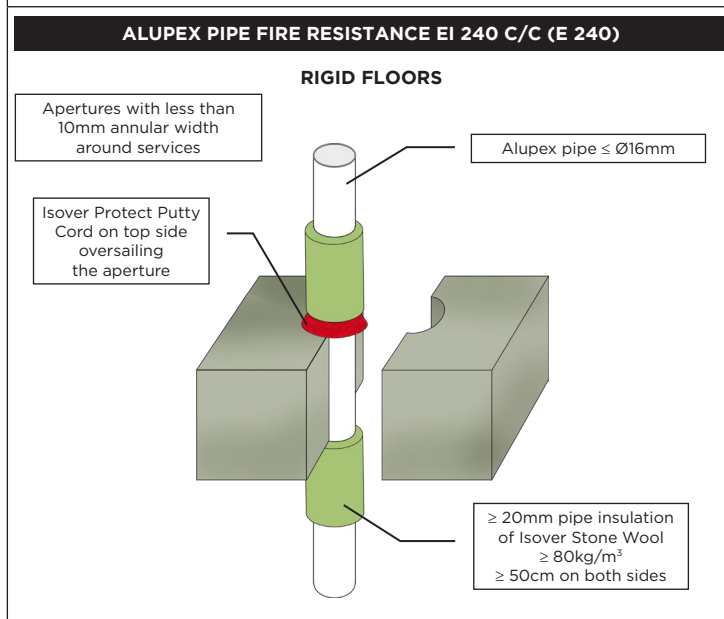
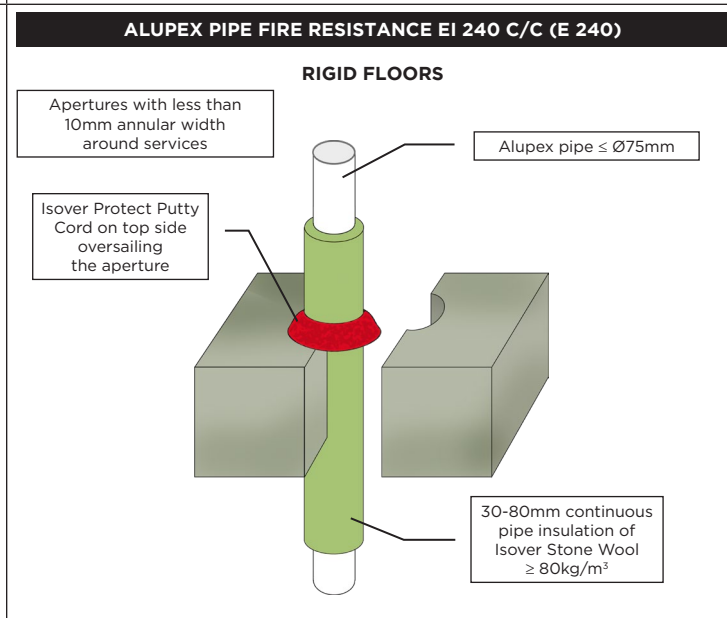
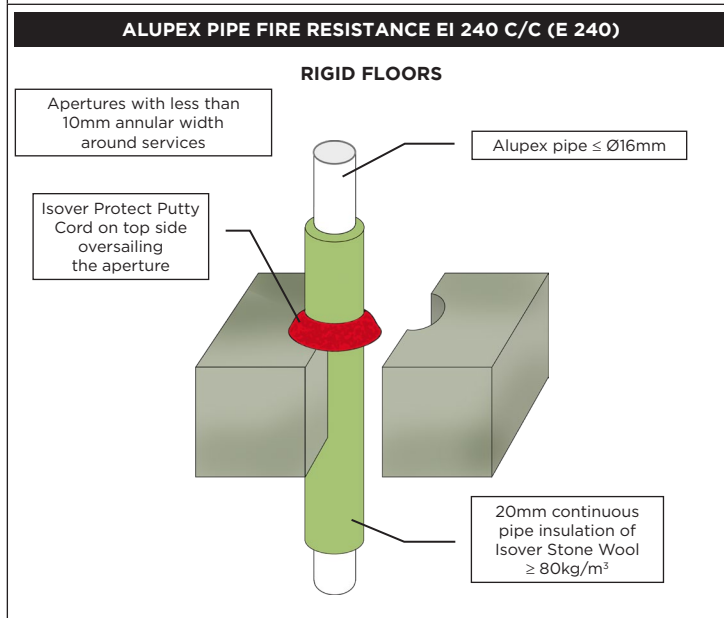
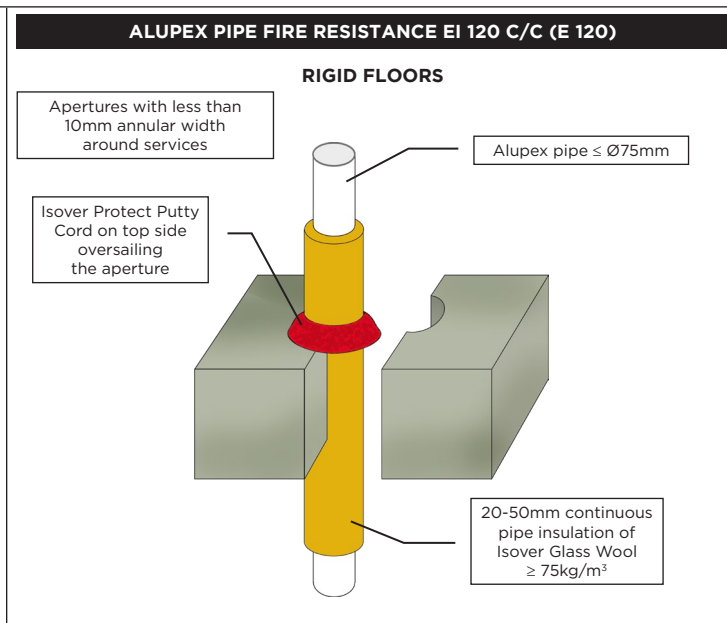
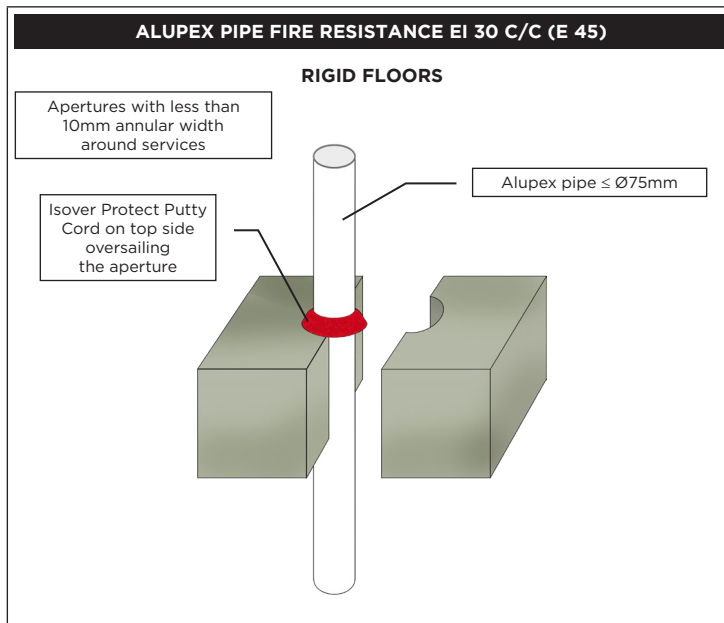

<p>STEEL PIPE FIRE RESISTANCE EI 120 C/U (E 120)</p> <p>MASONRY OR CONCRETE WALLS</p> <p>Apertures with less than 10mm annular width around services</p> <p>20mm continuous pipe insulation of Isover Stone Wool $\geq 80\text{kg/m}^3$</p> <p>Steel pipe $\leq \text{Ø}40\text{mm}$</p> <p>Isover Protect Putty Cord on both sides over-sailing the aperture</p>	<p>STEEL PIPE FIRE RESISTANCE EI 180 C/U (E 240)</p> <p>MASONRY OR CONCRETE WALLS</p> <p>Apertures with less than 10mm annular width around services</p> <p>30-80mm continuous pipe insulation of Isover Stone Wool $\geq 80\text{kg/m}^3$</p> <p>Steel pipe $\leq \text{Ø}324\text{mm}$</p> <p>Isover Protect Putty Cord on both sides over-sailing the aperture</p>
<p>COPPER OR STEEL PIPE FIRE RESISTANCE EI 120 C/C (E 240)</p> <p>MASONRY OR CONCRETE WALLS</p> <p>Apertures with less than 10mm annular width around services</p> <p>20mm continuous pipe insulation of Isover Stone Wool $\geq 80\text{kg/m}^3$</p> <p>Copper or steel pipe $\leq \text{Ø}54\text{mm}$</p> <p>Isover Protect Putty Cord on both sides over-sailing the aperture</p>	<p>ALUPEX PIPE FIRE RESISTANCE EI 240 C/C (E 240)</p> <p>MASONRY OR CONCRETE WALLS</p> <p>Apertures with less than 10mm annular width around services</p> <p>20mm continuous pipe insulation of Isover Stone Wool $\geq 80\text{kg/m}^3$</p> <p>Alupex pipe $\leq \text{Ø}16\text{mm}$</p> <p>Isover Protect Putty Cord on both sides over-sailing the aperture</p>
<p>ALUPEX PIPE FIRE RESISTANCE EI 240 C/C (E 240)</p> <p>MASONRY OR CONCRETE WALLS</p> <p>Apertures with less than 10mm annular width around services</p> <p>30mm continuous pipe insulation of Isover Stone Wool $\geq 80\text{kg/m}^3$</p> <p>Alupex pipe $\leq \text{Ø}75\text{mm}$</p> <p>Isover Protect Putty Cord on both sides over-sailing the aperture</p>	<p>BLANK SEAL FIRE RESISTANCE EI 120 (E 120)</p> <p>$\geq 100\text{MM}$ DRYWALLS, MASONRY OR CONCRETE WALLS</p> <p>Maximum aperture $\text{Ø}14\text{mm}$</p> <p>$\geq 25\text{mm}$ deep Isover Protect Putty Cord applied flush on both sides</p>

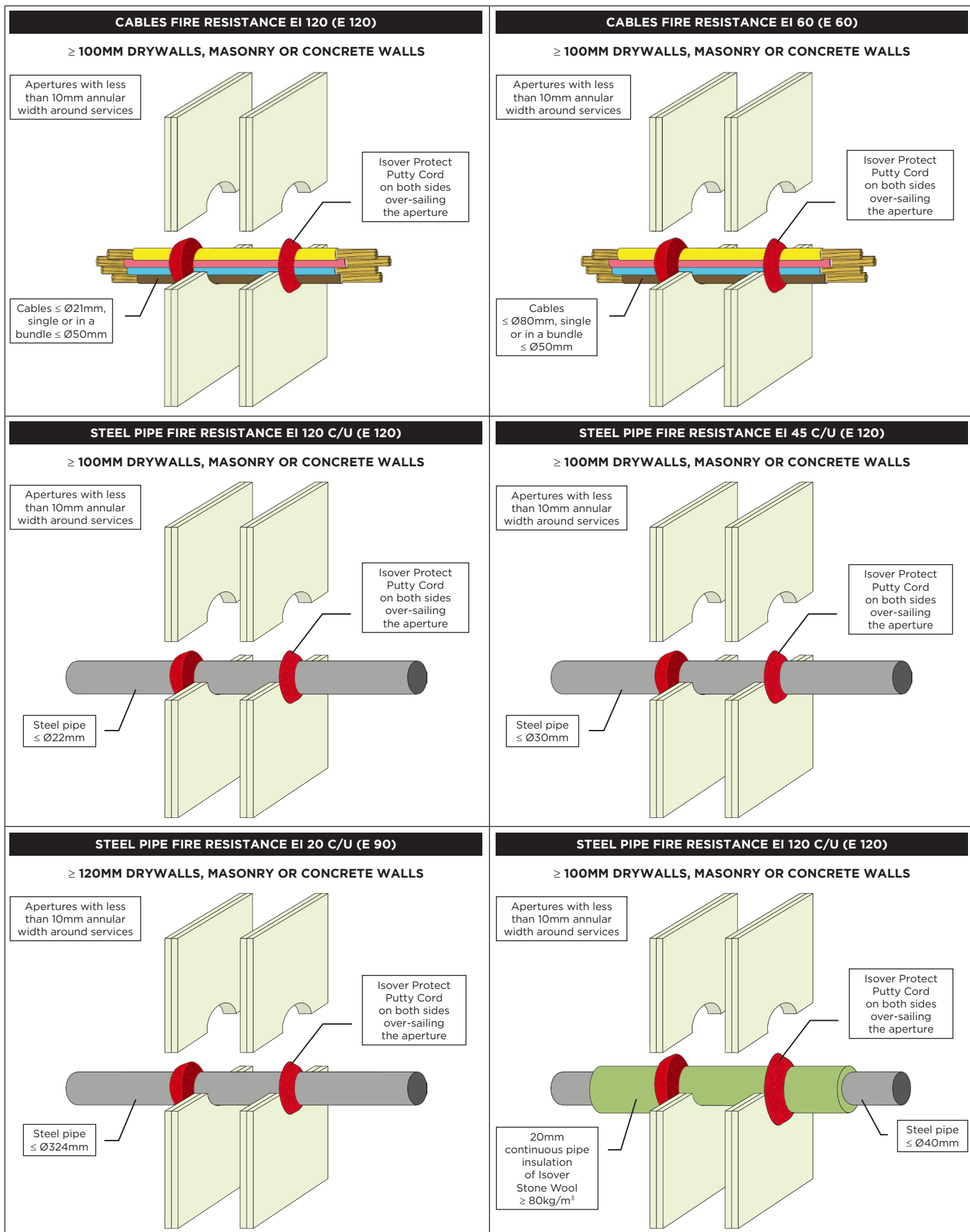

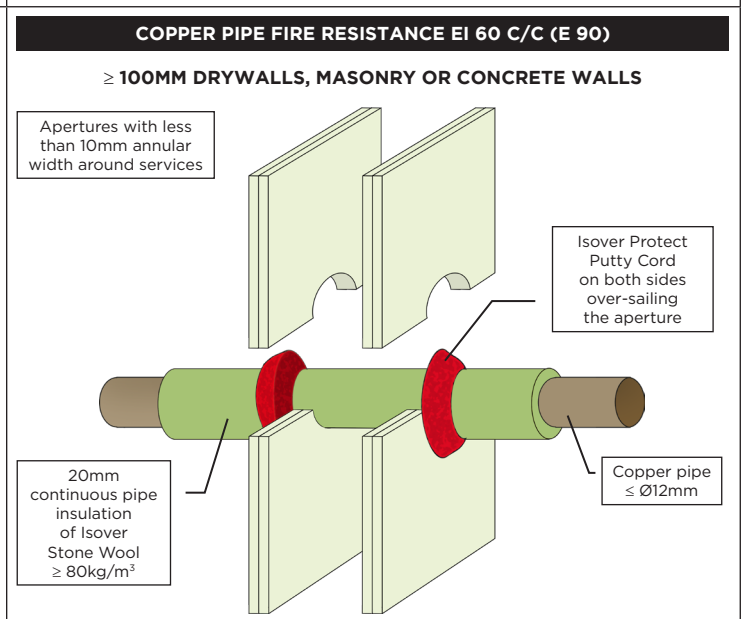
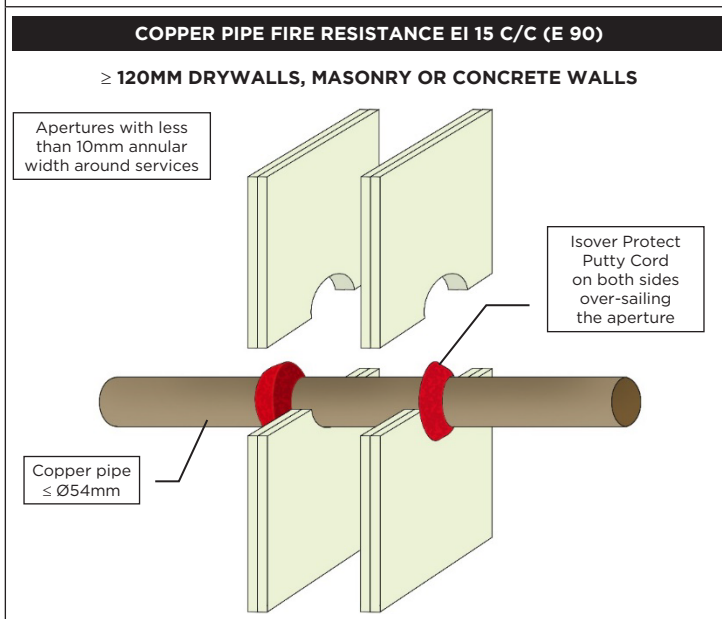
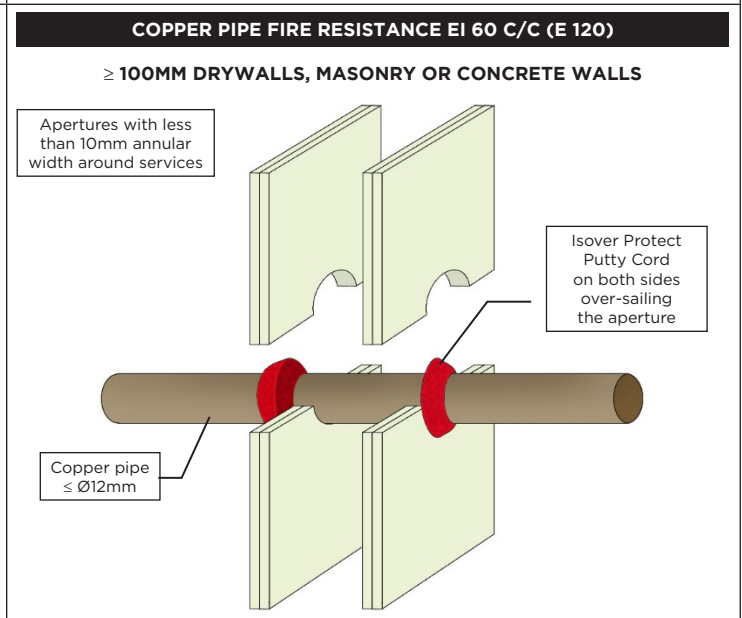
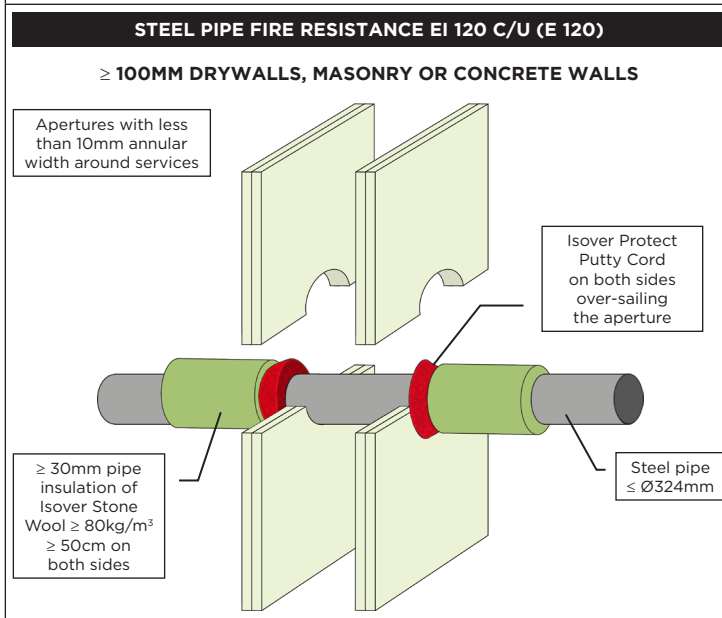
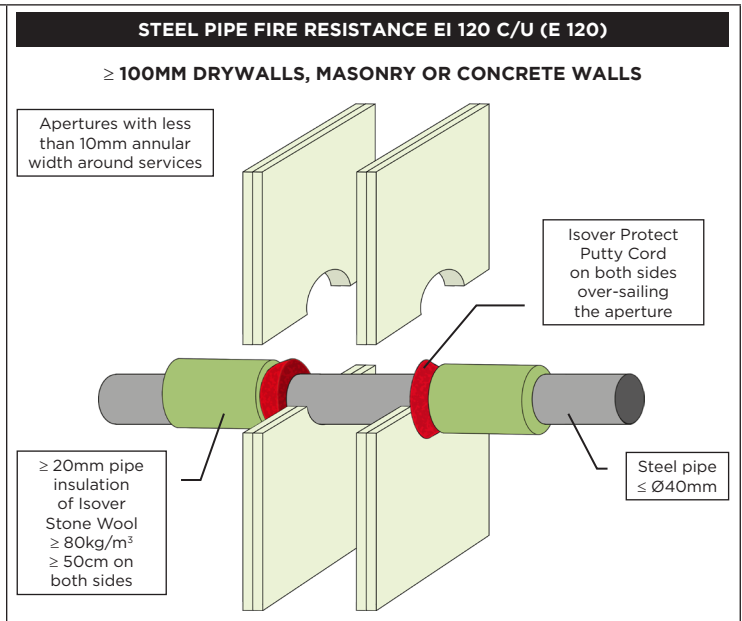
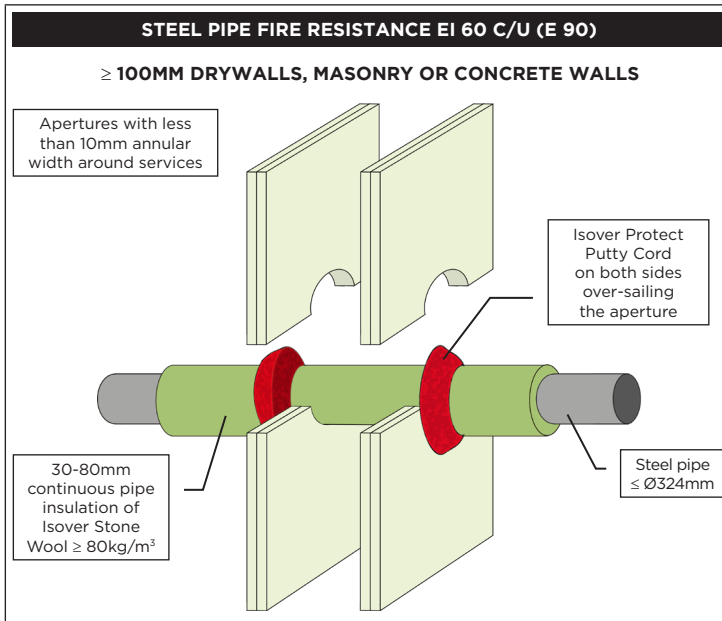

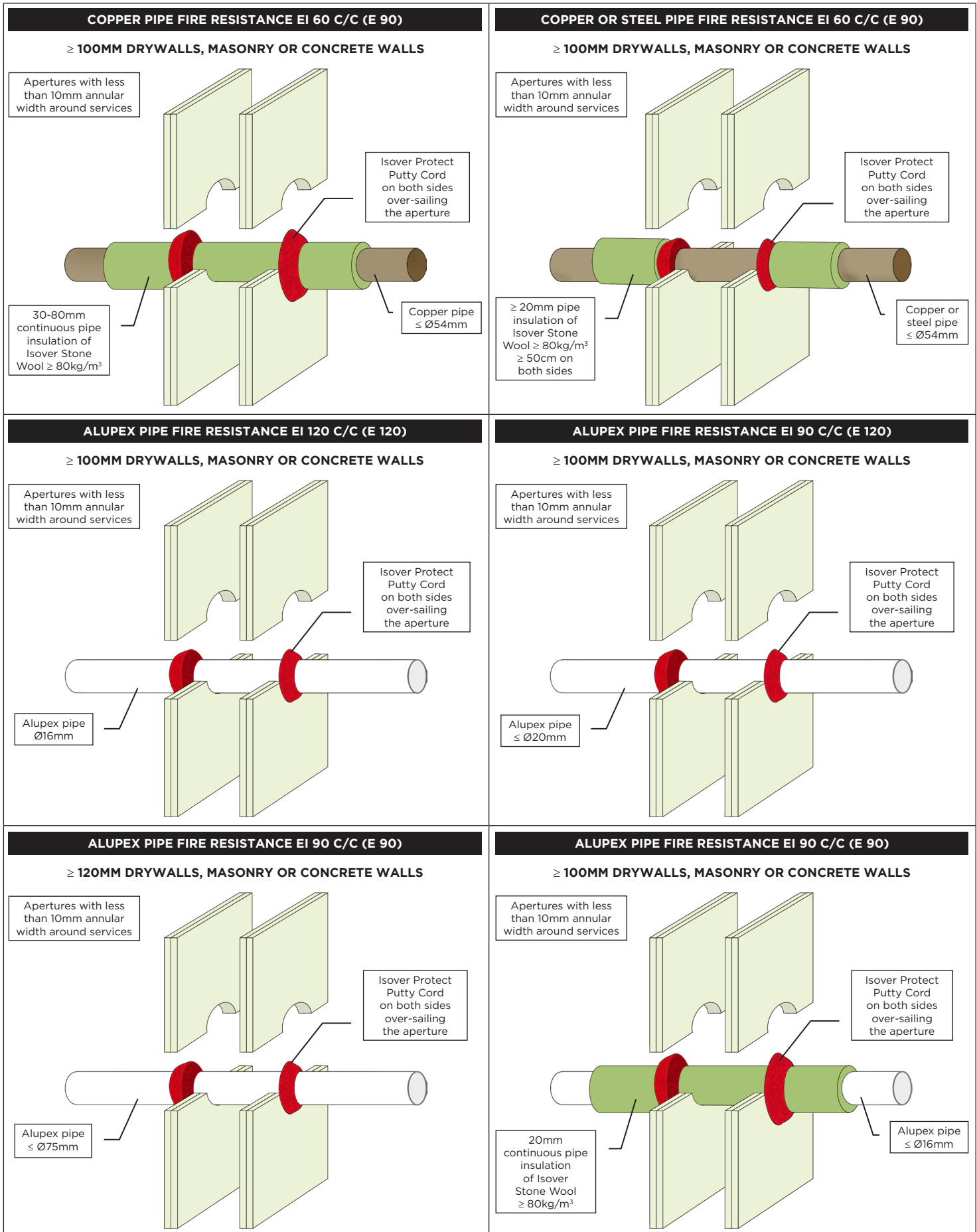

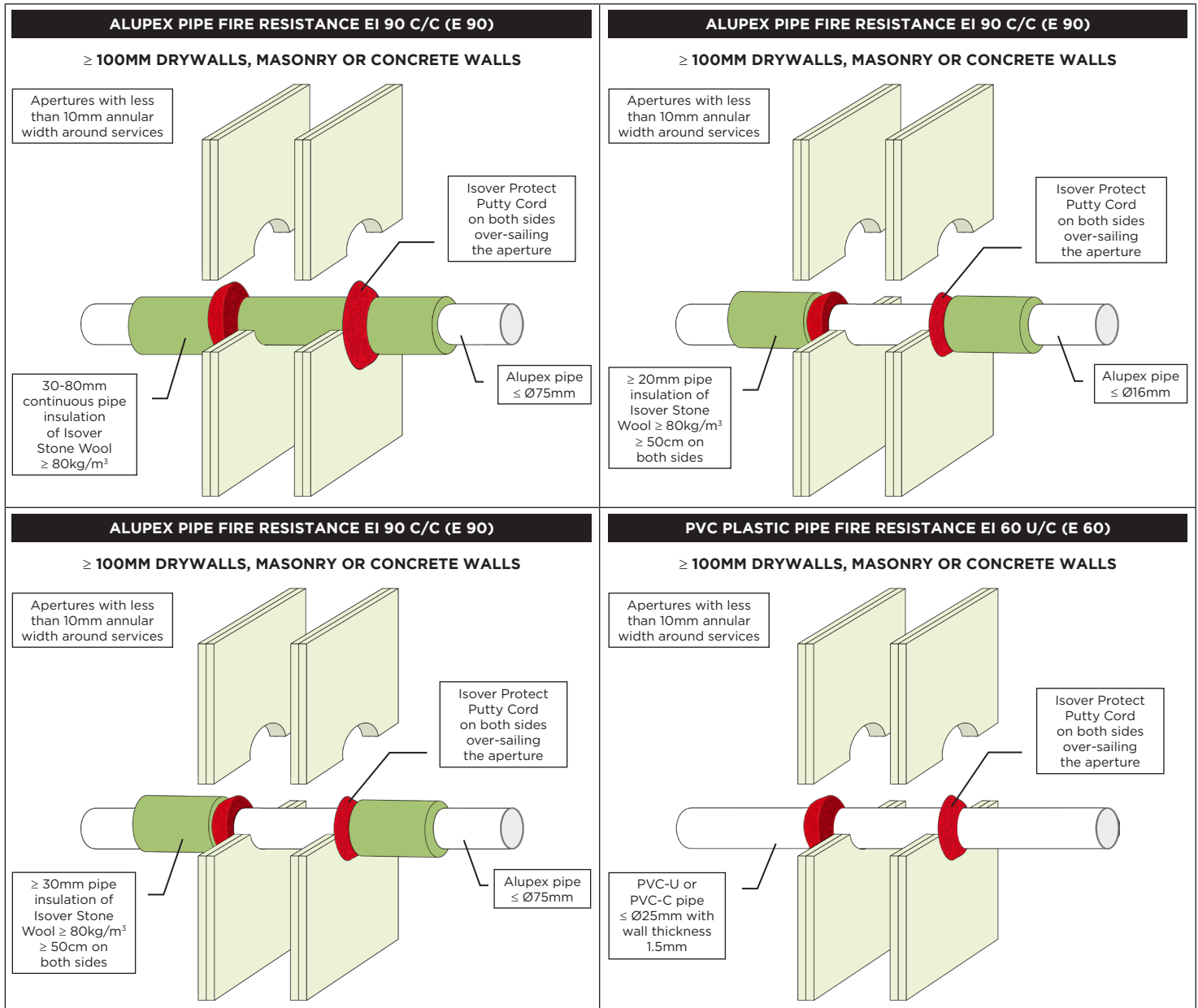

The information in this publication is consistent with current knowledge and our experiences at the time of printing (refer to the print note on the right side). Knowledge and experience are constantly evolving. Therefore, you must ensure to use the latest version of this publication. The described applications of the products cannot consider all the specific circumstances of each individual case. Therefore, you should verify the suitability of our products for the intended purpose. Our Technical Advisory is happy to answer any questions.



Saint-Gobain Denmark A/S, Isover

Østermarksvej 4
DK-6580 Vamdrup
Tel: +45 72 17 17 17
E-mail: Isover@isover.dk

www.isover.dk